

2 bobinages secondaires

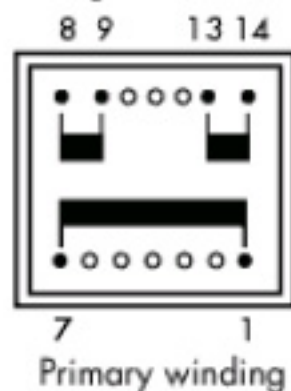

1 bobinage secondaire

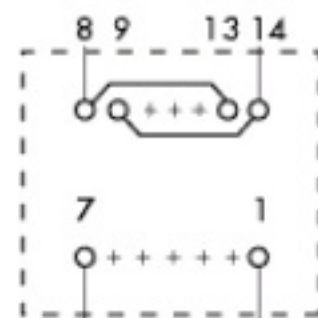
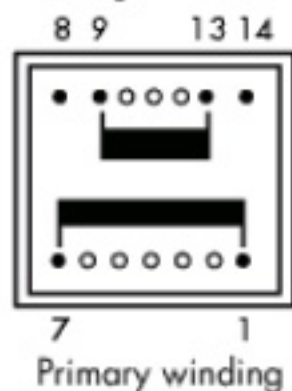

Recommended layout for transformers with 1 secondary winding (Allows the use of a transformer with 2 secondary winding)

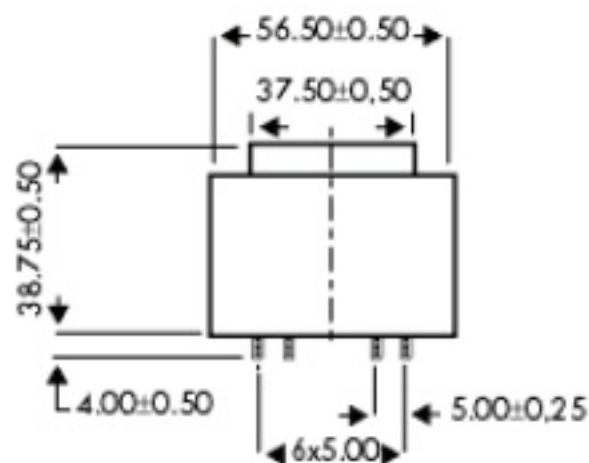

** RECOMMENDED DRILL-HOLE DIAMETER FOR 1,3 mm PINS

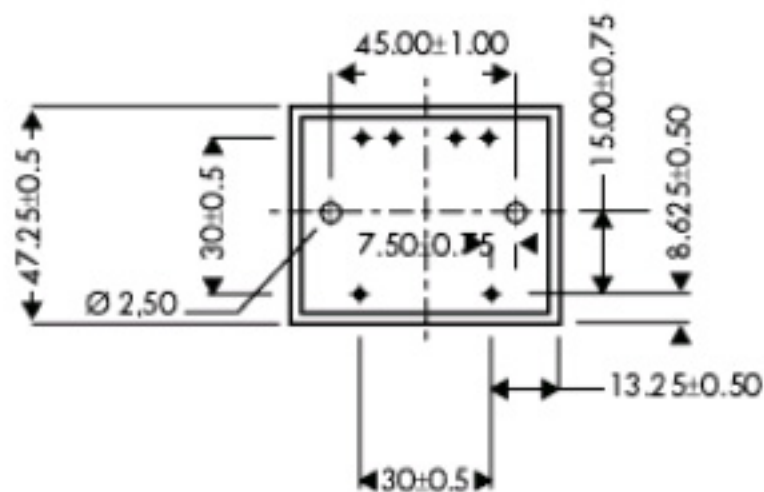

** RECOMMENDED DRILL-HOLE DIAMETER FOR MOUNTINGS = 4mm